

SETUP INSTRUCTIONS FOR 120" BAR WITH SIDE EXTENSION ON BTL

NOTES

STEP 1

LAY DOWN THE BAR'S 5 FRONT PANELS AS SHOWN. THE LABELS ARE ALSO SHOWN ON THE DIAGRAM TO THE RIGHT. YOUR WORK NEEDS TO MATCH WHAT IS SHOWN. THE LABELS 'D' SHOULD BE FACING THE FLOOR. ALL ELSE SHOULD BE FACING UP.

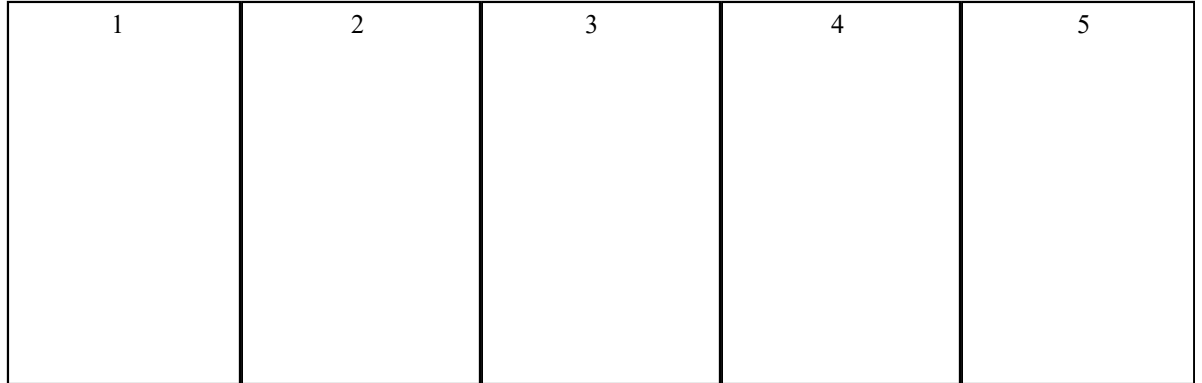

STEP 2

INSTALL THE BAR'S 9 SUPPORTING RAILS AS SHOWN (T1, T2, T3, B1, B2, B3). USE 1.25" SCREWS AND INSTALL TO PREDRILLED LOCATIONS

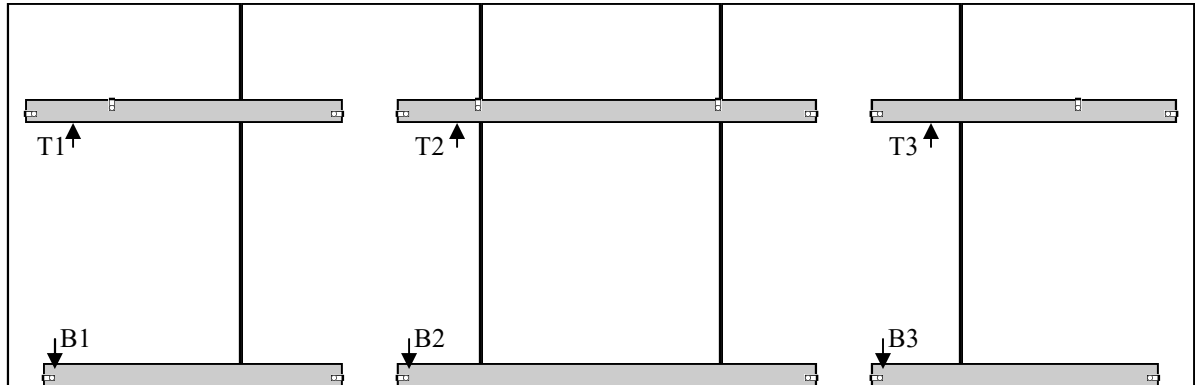

STEP 3

INSTALL THE BAR'S 4 SUPPORTING PANELS (S1, S2, S3, S4). USE 3/4" SCREWS AND INSTALL TO PREDRILLED LOCATIONS

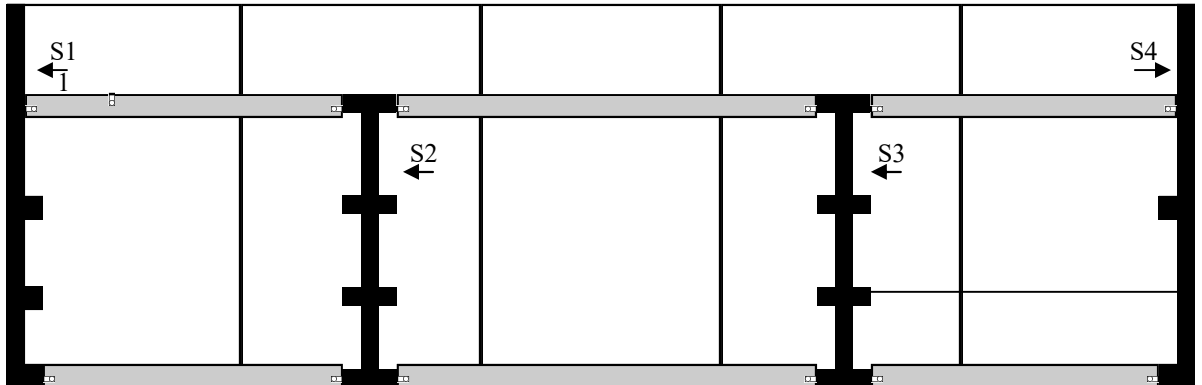

STEP 4

STAND THE BAR UP, AND SLIDE IN THE PROVIDED SHELVES.

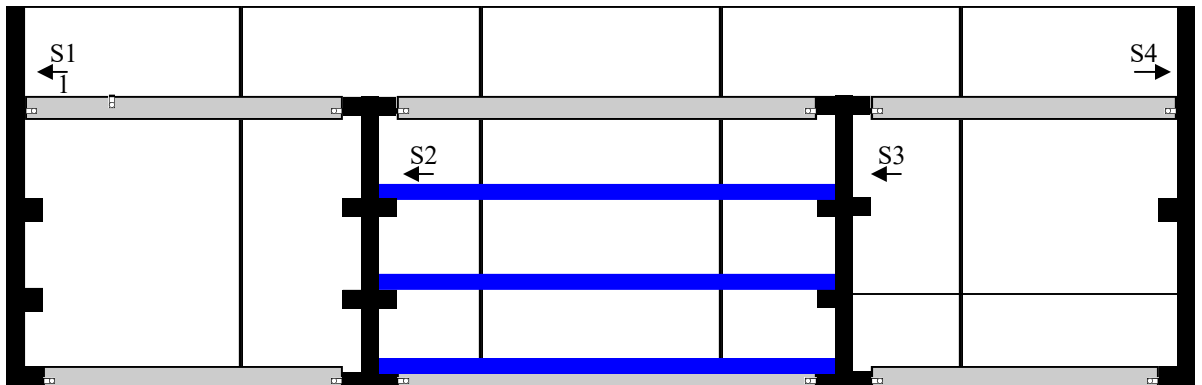

SETUP INSTRUCTIONS FOR 120" BAR WITH SIDE EXTENSION

BAR TOP (R)

BAR TOP (C)

BAR TOP (L)

STEP 5
INSTALL THE BAR TOP.
USE 3/4" SCREWS AND
INSTALL TO PREDRILLED
LOCATIONS.

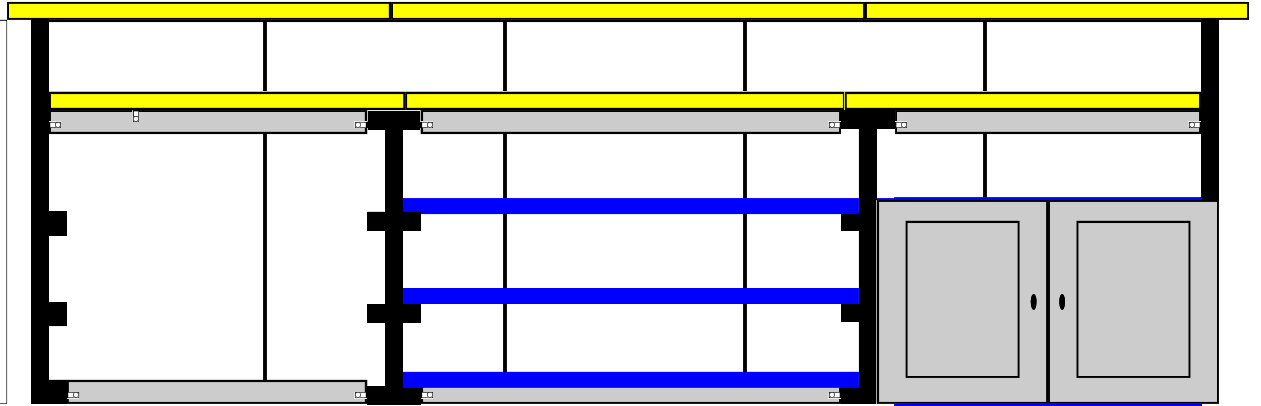

CABINET DOORS
NOT
ON EVERY
MODEL

NOTES